

- ◆ Read and observe all safety warnings and instructions in the Installation & Operation Manual before dampener installation, operation or repair.
- ◆ **WARNING!** Remove all pressure from dampener AND pumping system before disassembly, removal or maintenance.
- △ To avoid possible damage to bladder/bellows from a system pressure test:
  - Adjustable and Chargeable models** — charge dampener to 80% of the system test pressure prior to test.
  - Automatic model** — prior to test, dampener must be equipped with a constant source of compressed air with pressure equal to or greater than system test pressure.
  - Inlet Stabilizer model** — maximum pressure test 30 psi (2.0 bar), charge to 20 psi (1.3 bar) for system pressure test.

### Disassembly

- △ **IMPORTANT!** Before disassembly, use a marker to draw a line across both the top and bottom halves of the dampener where the threads meet (see Figure 1). This will ensure proper tightening upon reassembly.

1. Place dampener in a vise with soft jaws or wooden blocks to protect dampener body.
2. Use a spanner wrench or large adjustable pliers to grab the flats on the top half and turn the section counter clockwise to separate the two halves of the dampener.
3. Inspect the threads in both halves of dampener for damage. Order replacement parts as needed; consult factory for part numbers.
4. Inspect the bladder/bellows for failure. Order replacement parts as needed; consult factory for part numbers.

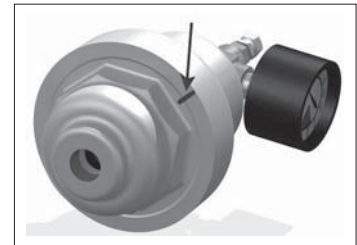
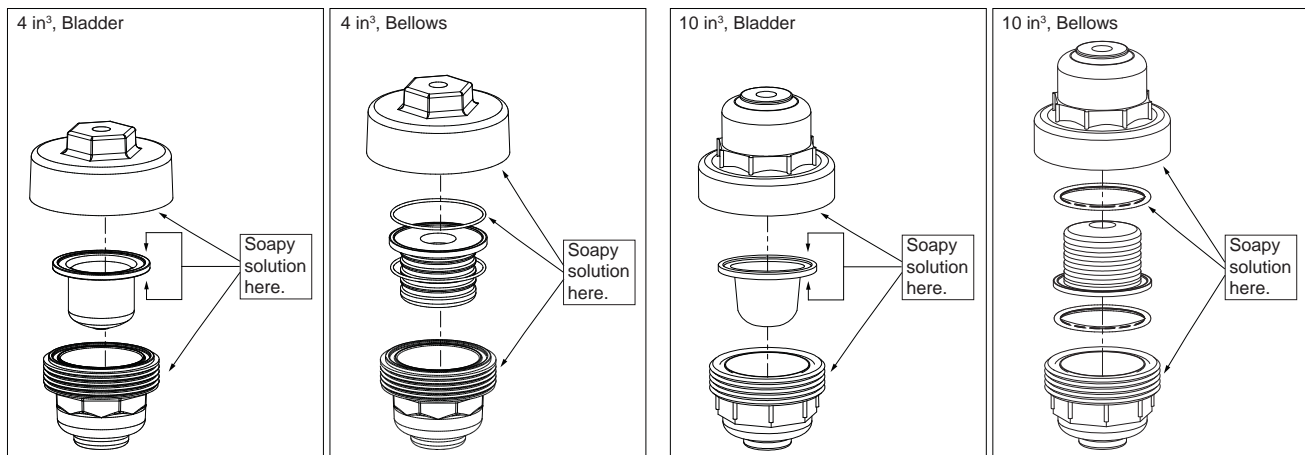

Figure 1

### Assembly

1. Make sure dampener threads are clean and undamaged.
2. Apply a solution of soap and water as a lubricant to the bladder/bellows sealing ring and threads of the two dampener halves (see Figure 2). The bladder/bellows sealing ring is used to seal the two halves of the dampener together. The PTFE bellows uses two O-rings. Make sure the PTFE encapsulated O-ring is placed in the bottom (wetted) half bellows groove. Lubrication is critical so that the ring groove in each half of dampener will seat against the bladder/bellows sealing ring smoothly and without distortion.
3. Hand tighten the two dampener halves together until snug.
4. Place dampener in a vise with soft jaws or wooden blocks. Use adjustable pliers to tighten the two dampener halves together until the lines marked on the dampener halves before disassembly line up (see Figure 1).
5. Reinstall dampener air control assembly if previously removed.
6. Refer to dampener Installation and Operation Manual for instructions on dampener charging, testing and installation.

Figure 2



M46E11\_020